

# YB-100N(LED) Varenummer 28000261



## Multi-Functional Electric Bolt with Magnetic Sensor



### Product overview

YB-100N(LED) is a multi-functional fail safe electric bolt with double protection for loading current.suitable for glass door, wooden door, metal door . We supply integrated equipment to collocate with fully frameless glass door, swing-in door and so on. Build-in Photoelectricity control and low temperture design.

### Dimensions

Unit: mm

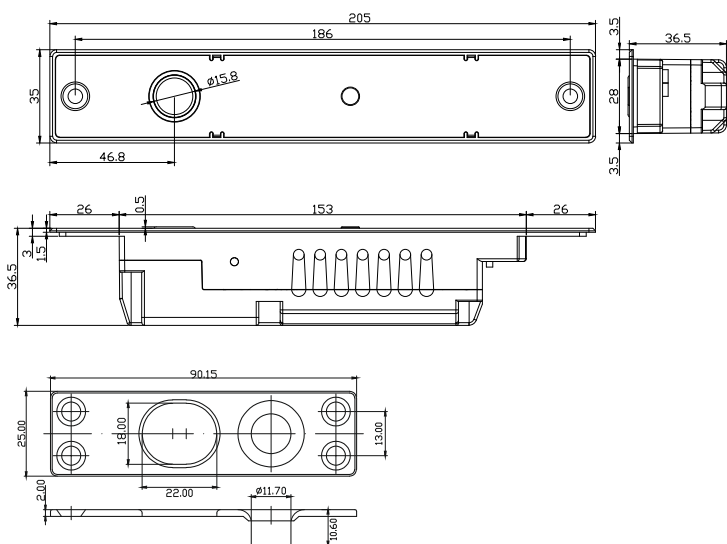

Magnetic Plate

### Installation diagram

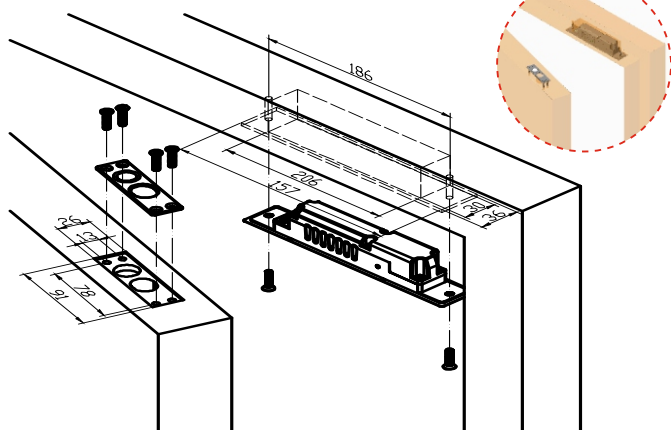

Installation on top for solid door

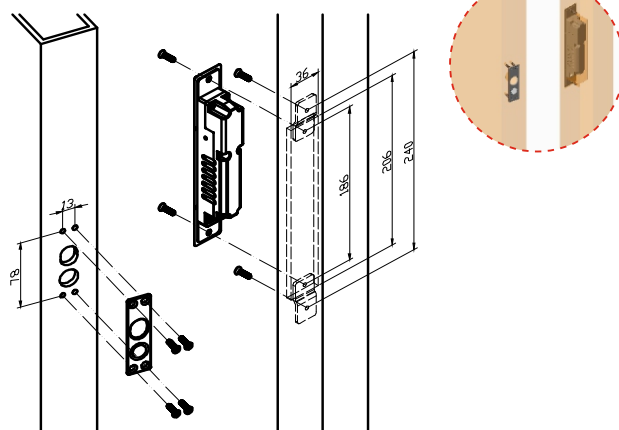

Side installation for hollow door

Parameter/Model	YB-100N(LED)
Parameter	Description
Feature	Fail Safe
Face Plate	205Lx35Wx36.5H(mm)
Strike	90Lx25Wx2H(mm)
Voltage	12VDC/24VDC(Adjustable)
Current	Start12V/ 980mA(+10%),Standby 12V/ 180mA Start24V/ 650mA(+10%),Standby 24V/ 120mA
Signal Output	5 Line: Door Status Signal:NO、 COM 8 Line:Door Status Signal:NO、 COM ; Lock Status Signal:NO、 NC、 COM
LED	Green for unlocking while red for locking
Induction Distance	4-8mm
Suitable For	Wooden Door,Glass Door,Metal Door
Weight	0.55kg

## Suitable for double action doors

Electric bolts are specially designed for double action doors. They can also be installed on both in-swing doors and out-swing doors.

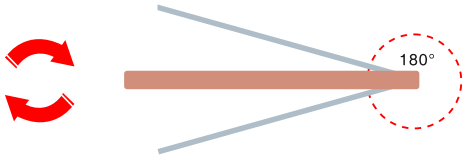

## Optional brackets

It depends on the types of your doors. We have many kinds of brackets for narrow frame doors, frame-less glass doors and in-swing doors.

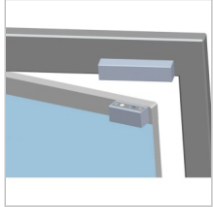

BBK-500

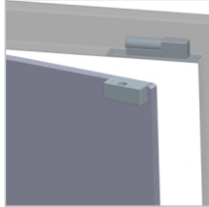

BBK-601



BBK-700

## Auto-lock time delay

This can be set up from 0 to 9 seconds by adjusting the jumpers.



## Energy saving design

When the bolt is extended to keep the door locked, it draws only 850mA in a holding mode. This design extends the life of the electric bolt.

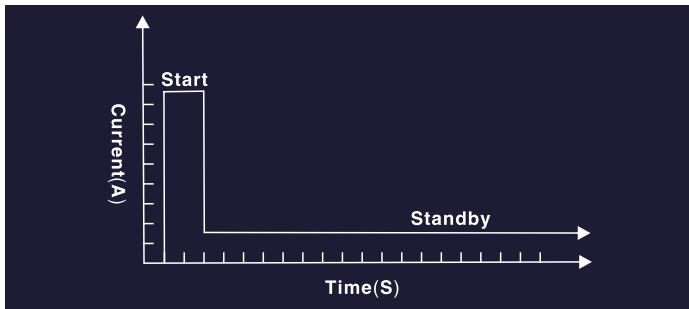

## Photoelectric sensor control

Instead of using electric components, we use photoelectric components to make the bolt more stable and durable. In the same time, it can increase the lifetime of the bolt.

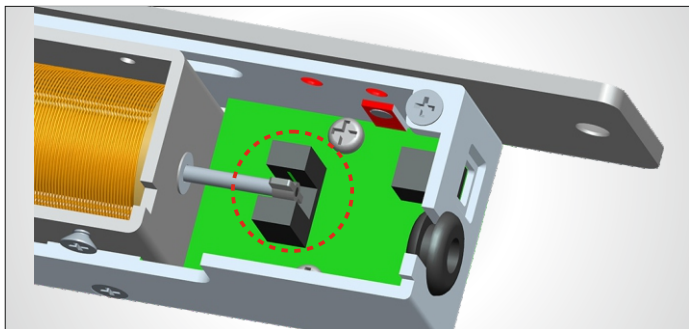

## Auto-detective circuitry

This special auto-detective circuit of electric bolt keeps the bolt retracted while the door unlocked or improperly aligned until the door is properly closed.

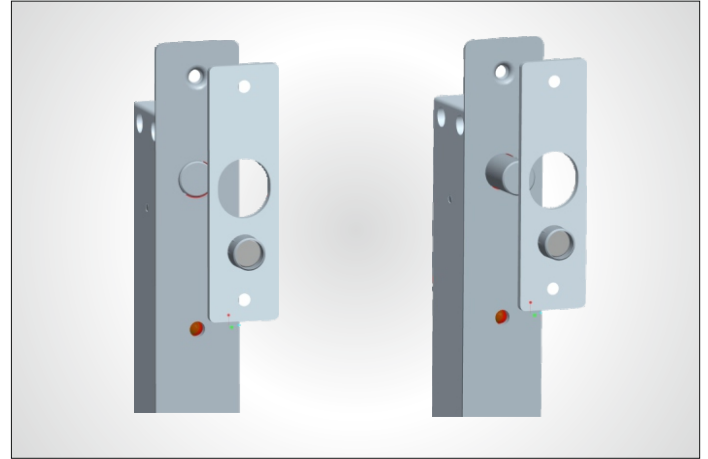

## Vandal resistant circuitry

The reed sensor will automatically disconnect when the door is actually closed in order to enhance the security of the lock.

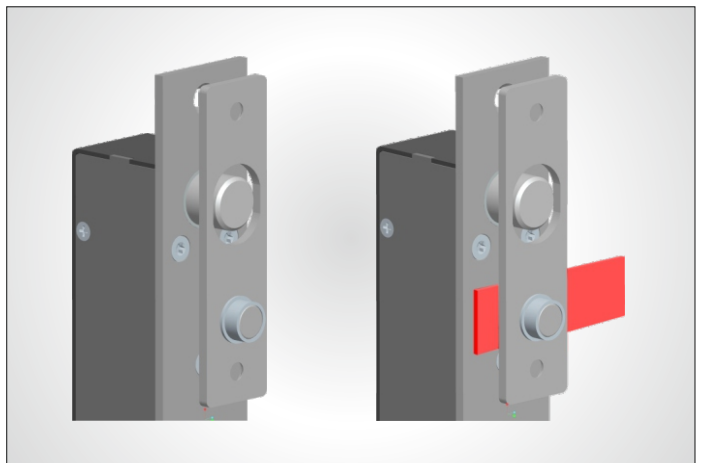





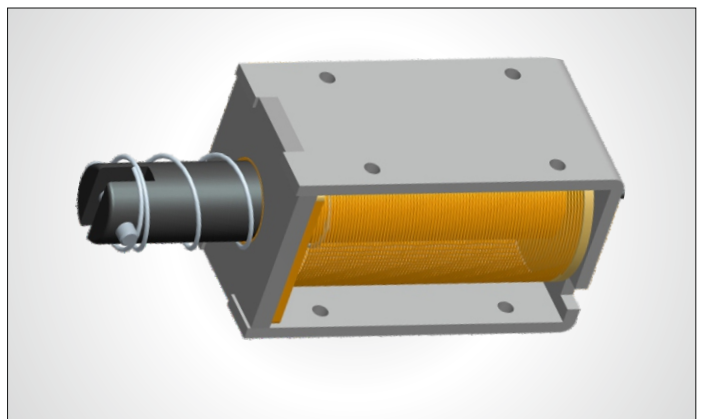





## Ultra durable solenoid valve

Tested for over 500,000 times, the specially designed solenoid valve can be used for 5 to 10 years.

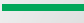

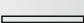
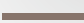
Connecting instructions

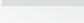
With the special auto-detective circuit, we advise you to connect our own open wires to open the door instead of shutting off the power directly.

	Red		+	
	Black		-	
	Orange		OPEN	
	Green		NO	} Door Status Signal Output
	White		COM	
	Brown		NC	} Look Status Signal Output
	Grey		COM	
	Blue		NO	

Setting

It comes with feature of 12v/24v self-switching

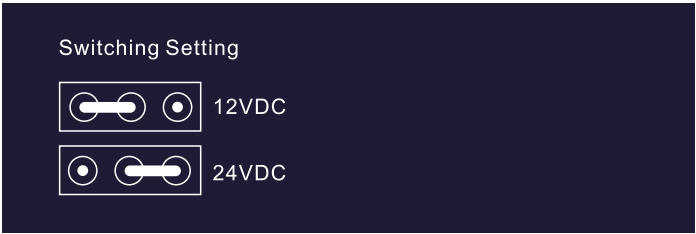

304 stainless steel solid bolt

Made by CNC lathe, this 304 Stainless Steel bolt has 1000kg holding force, which is stronger and more durable under the harsh environment.

